

# apartments // 02

- doors
- windows
- walls

one meter

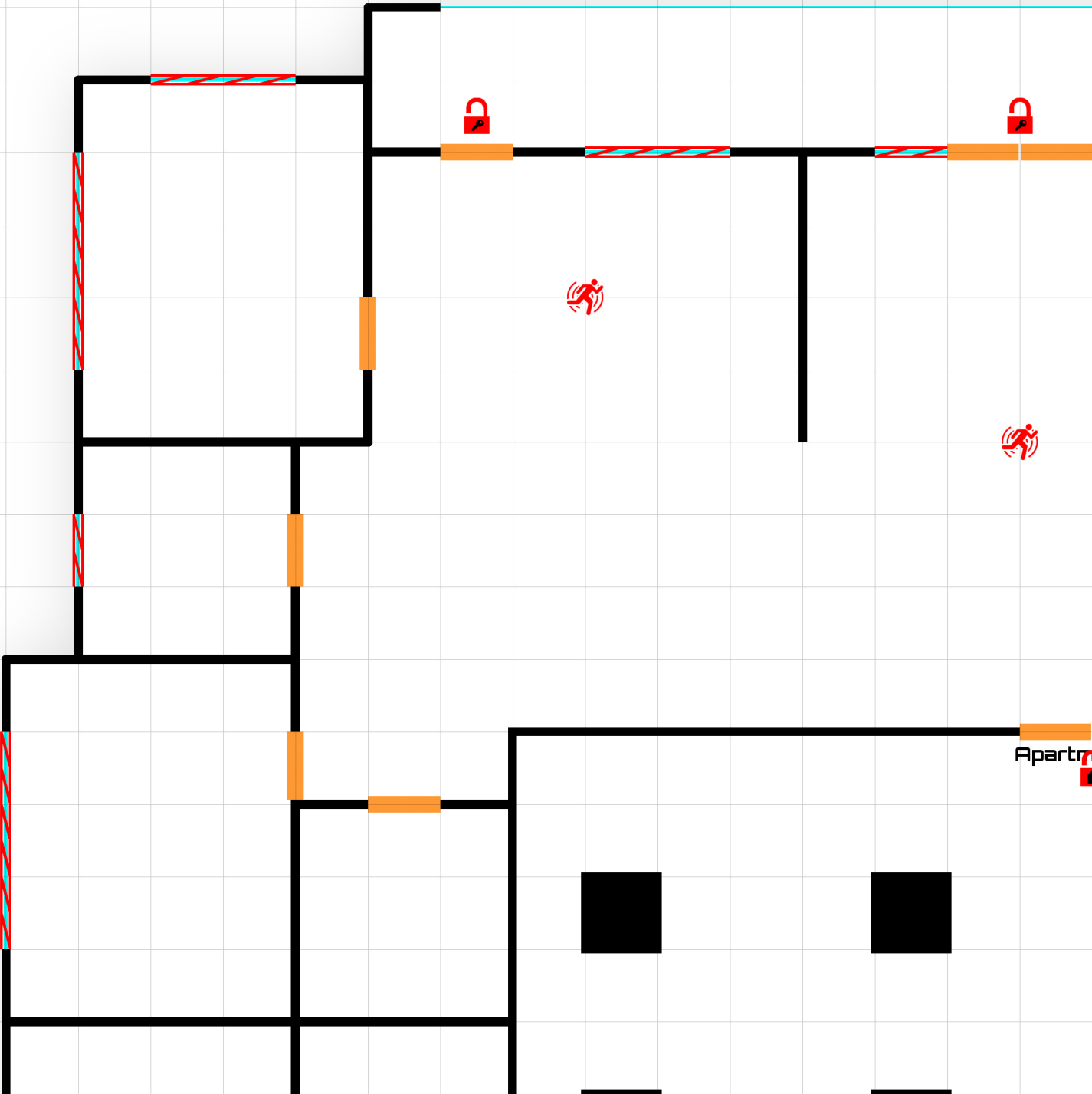

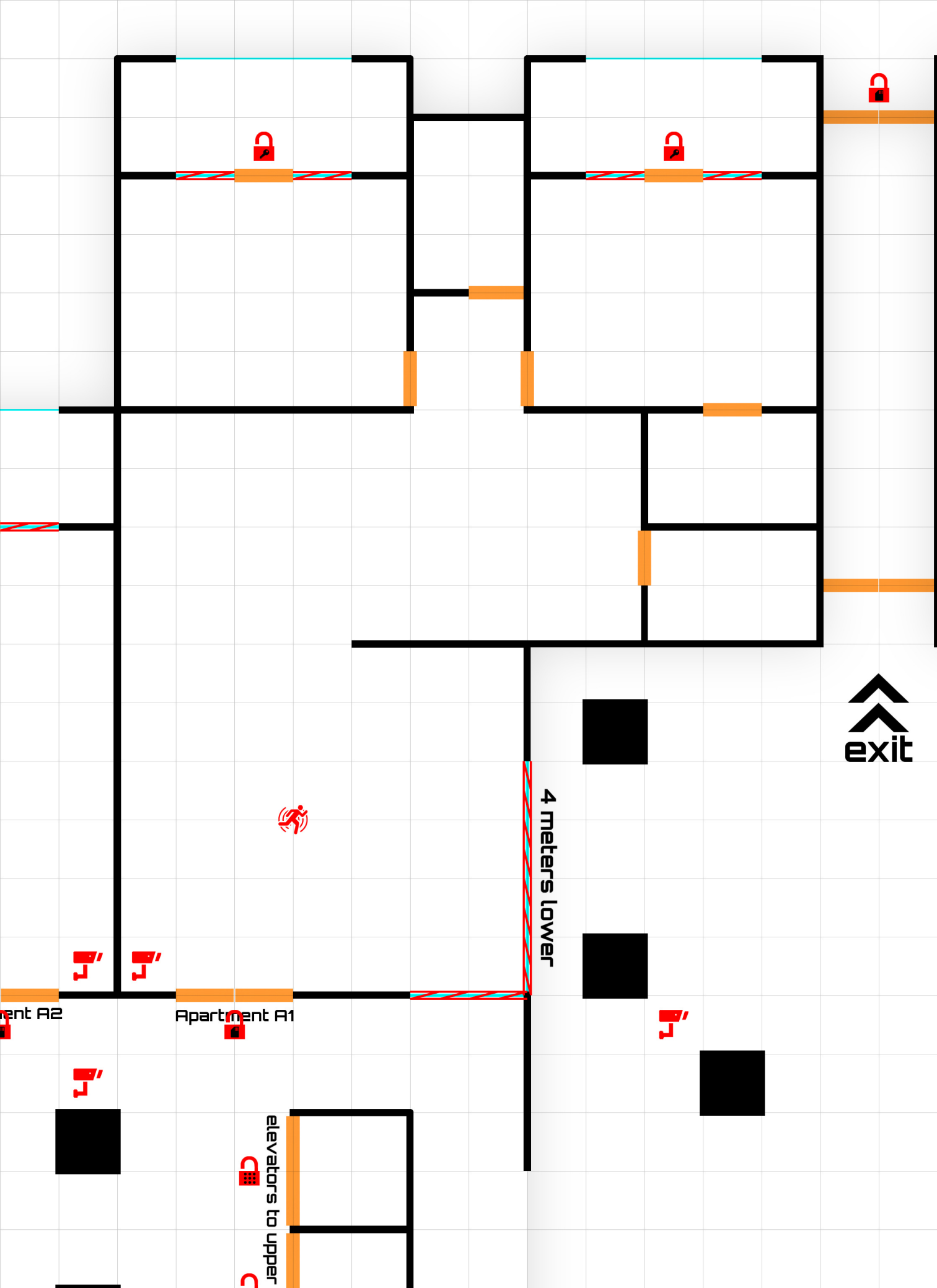

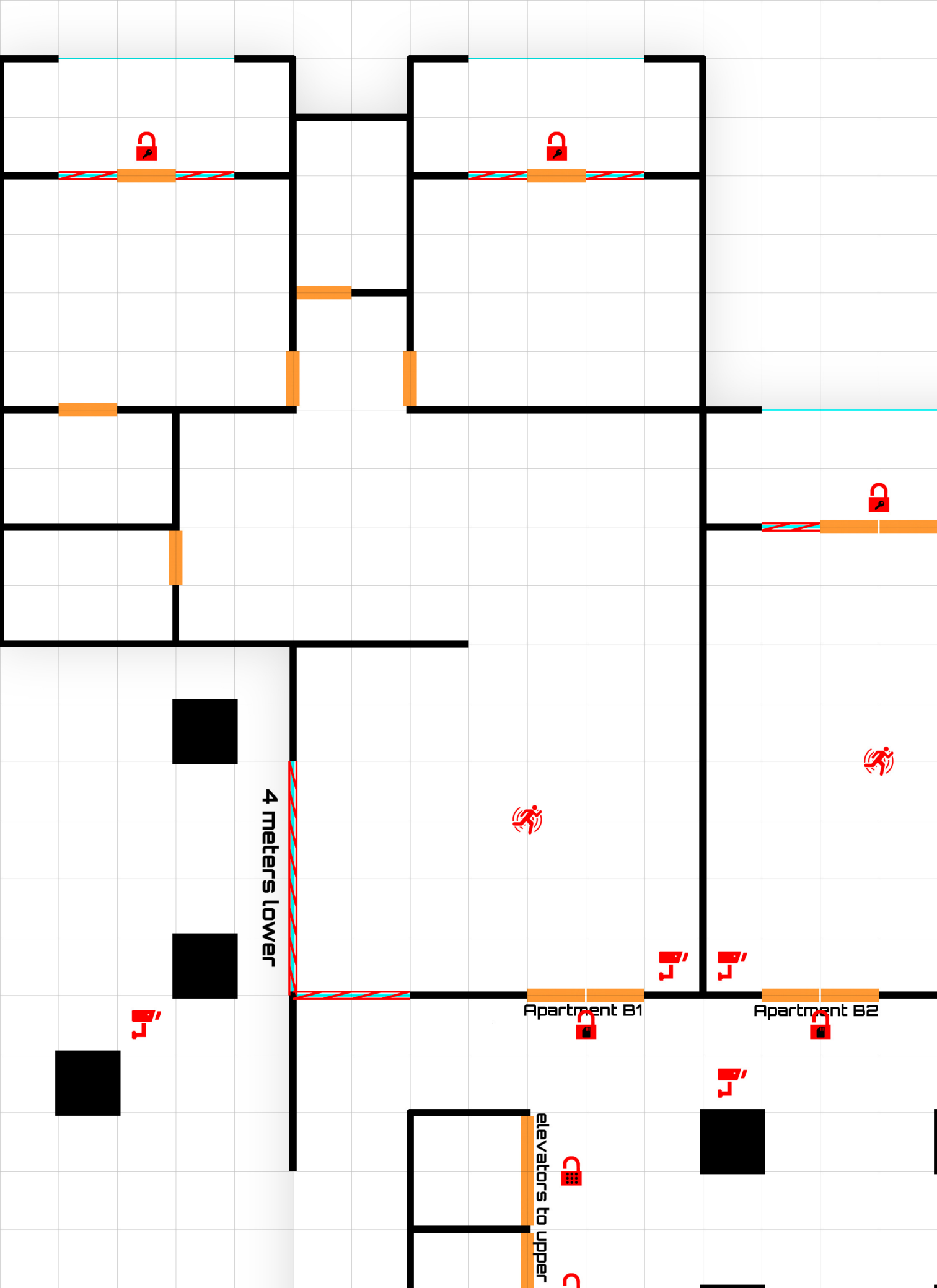

4 meters lower

Apartment B1

Apartment B2

elevators to upper

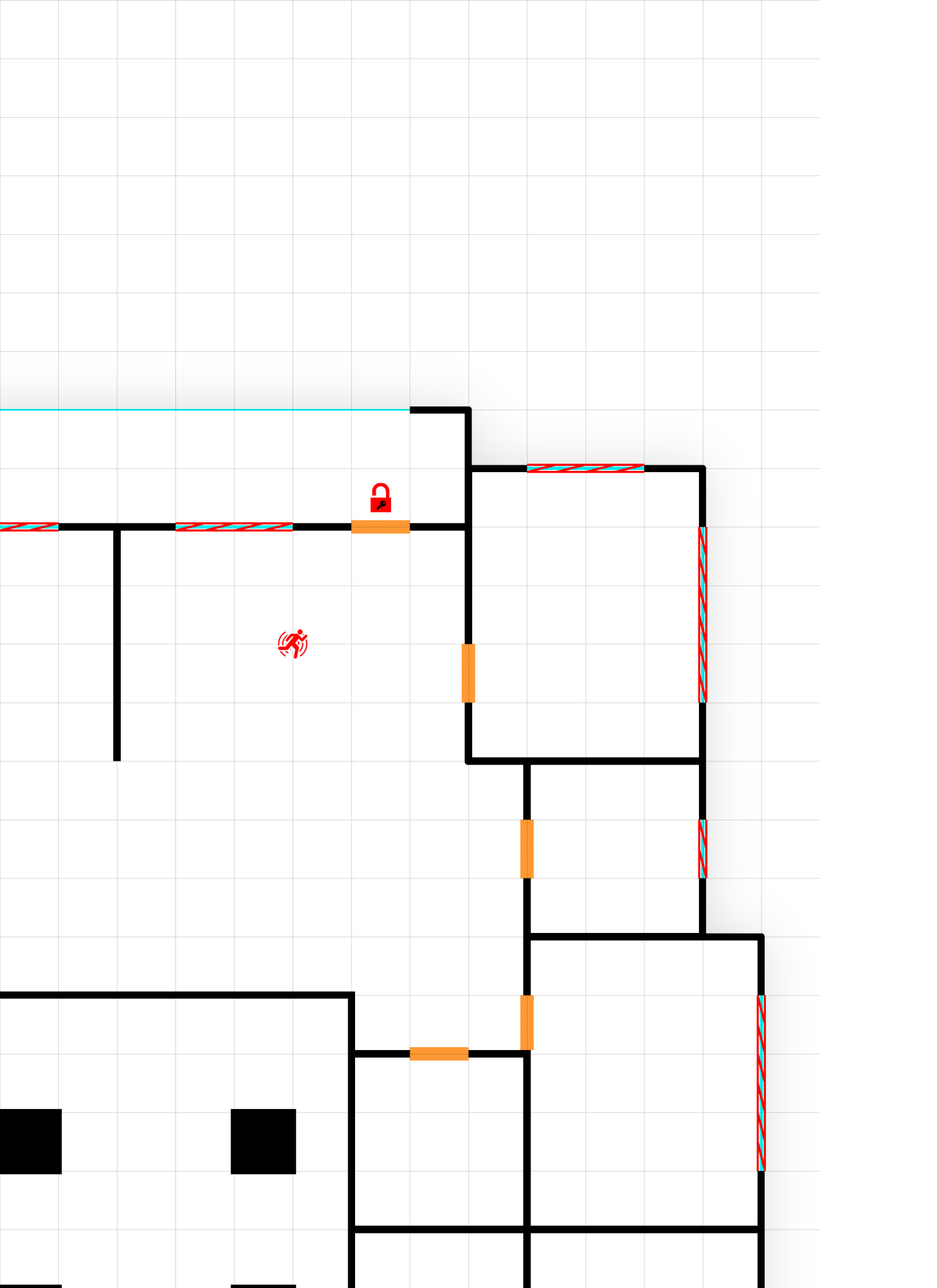

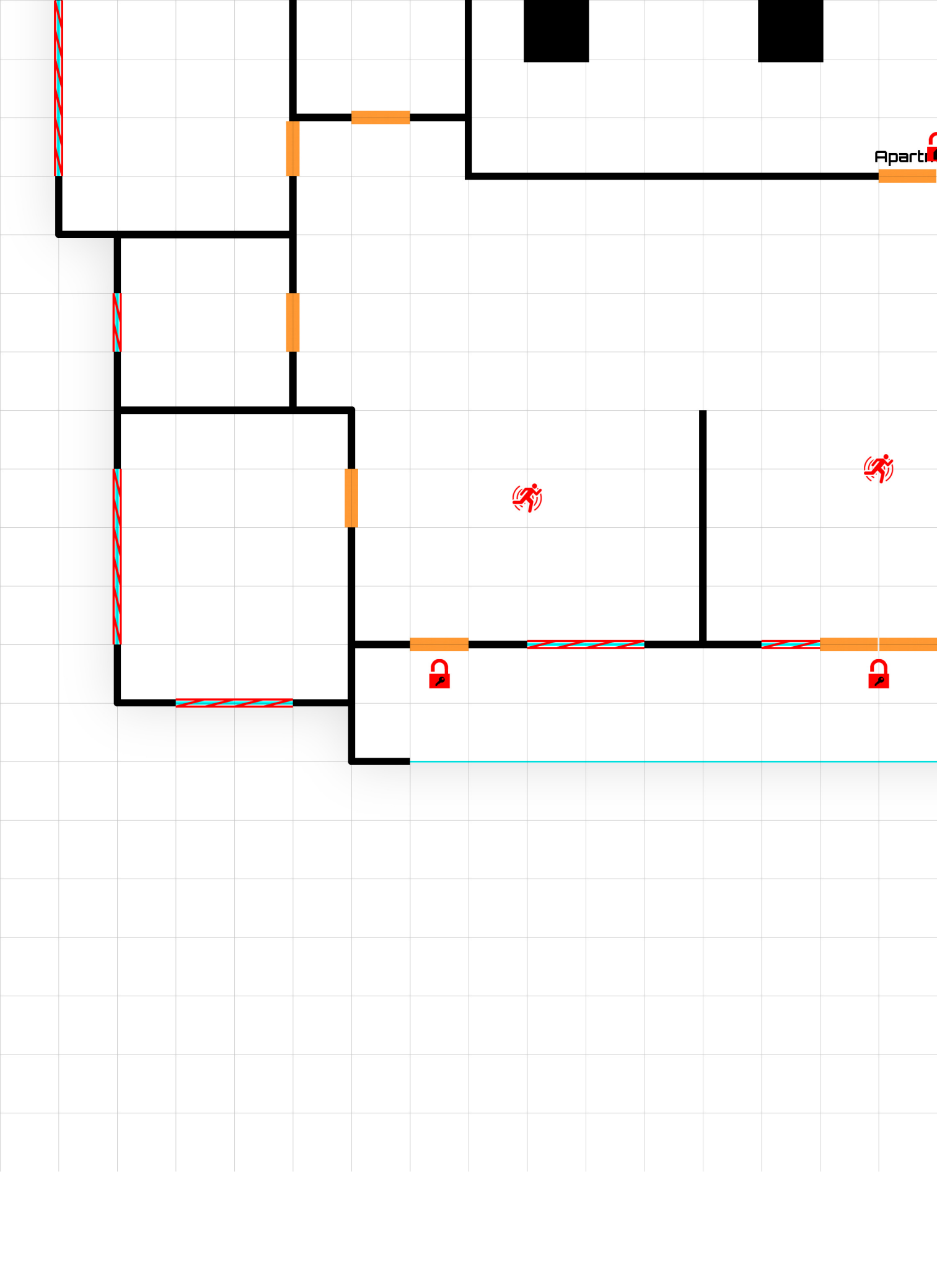

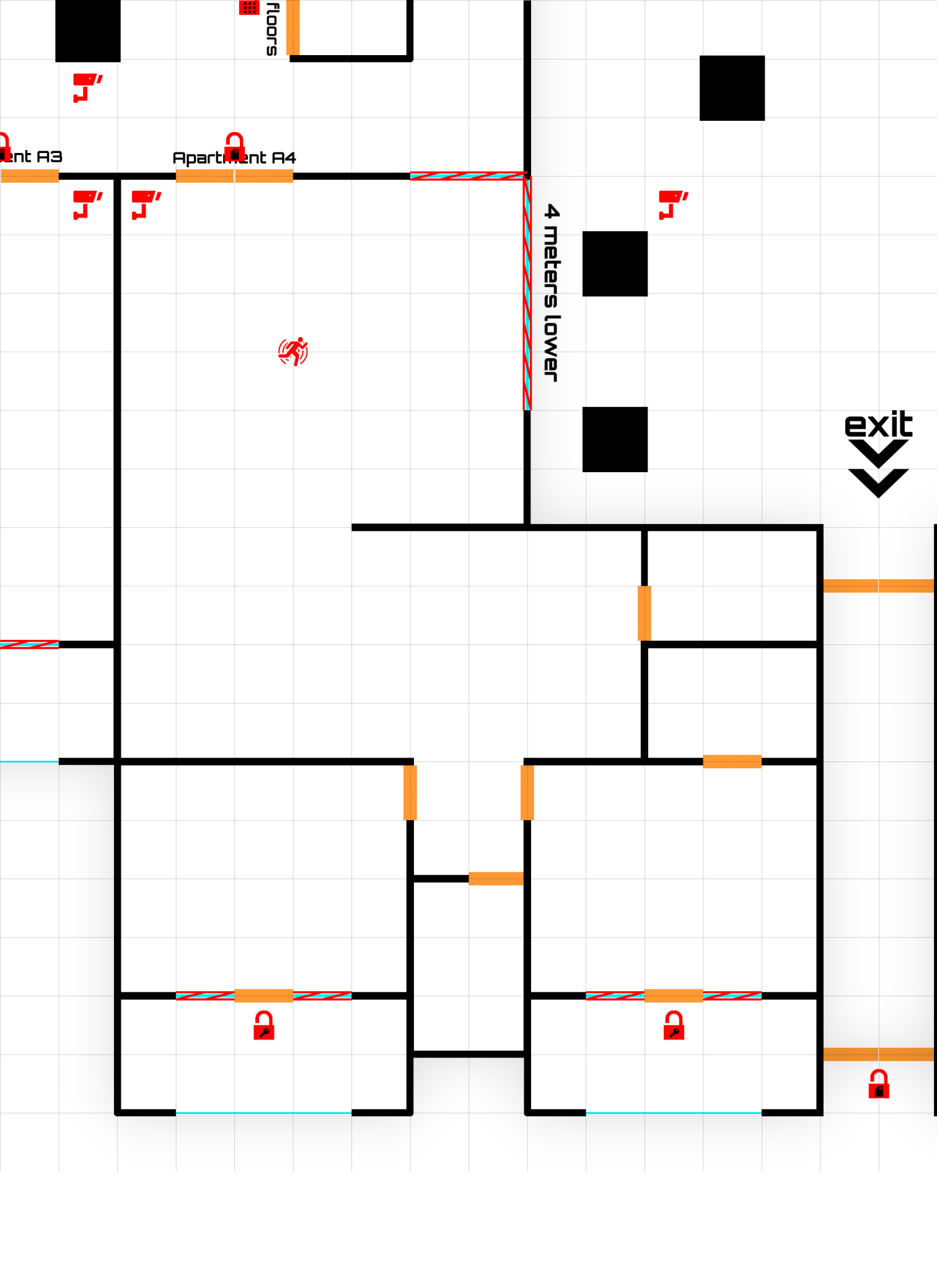

Floors

Apartment A3

Apartment A4



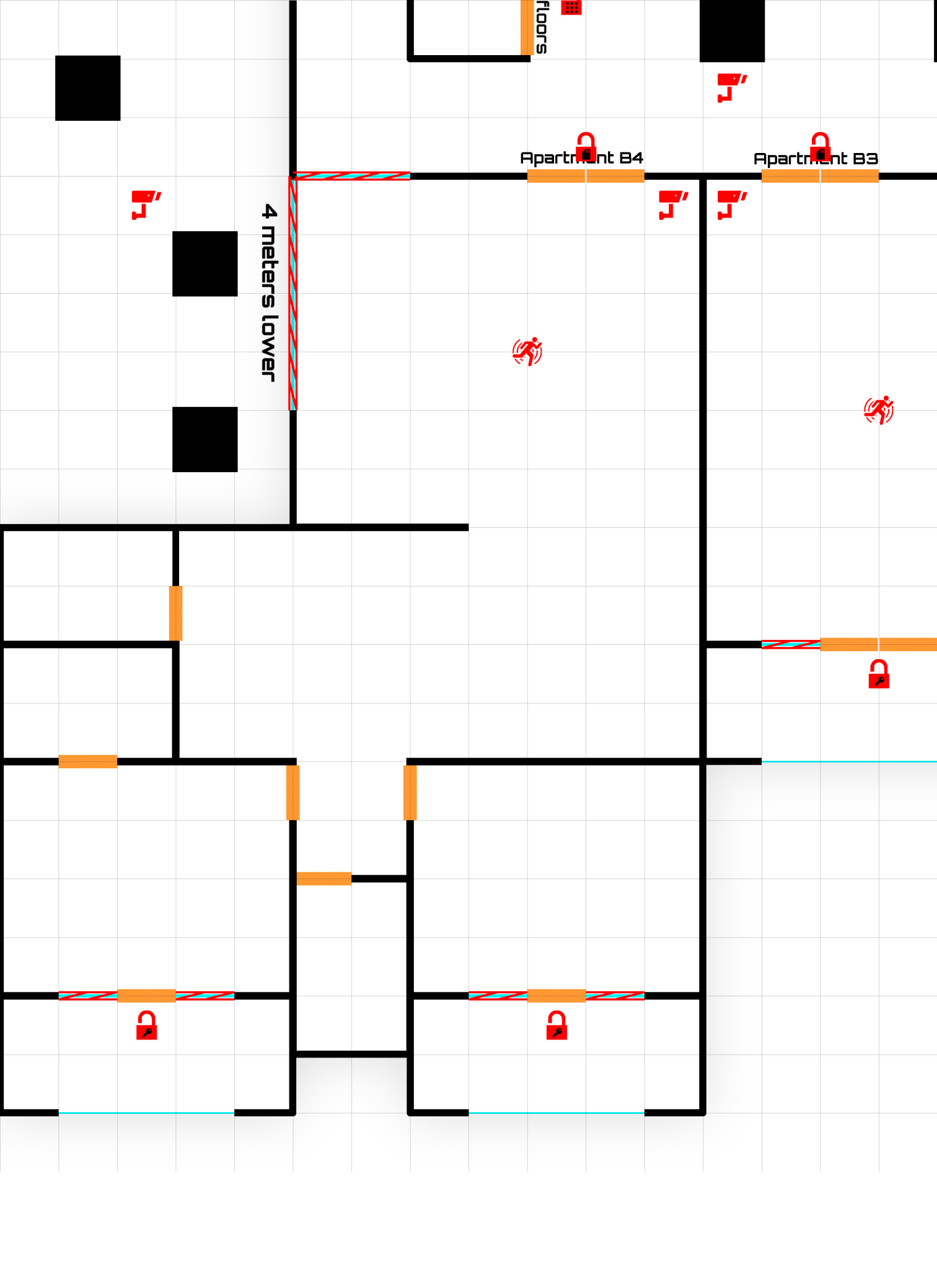

4 meters lower

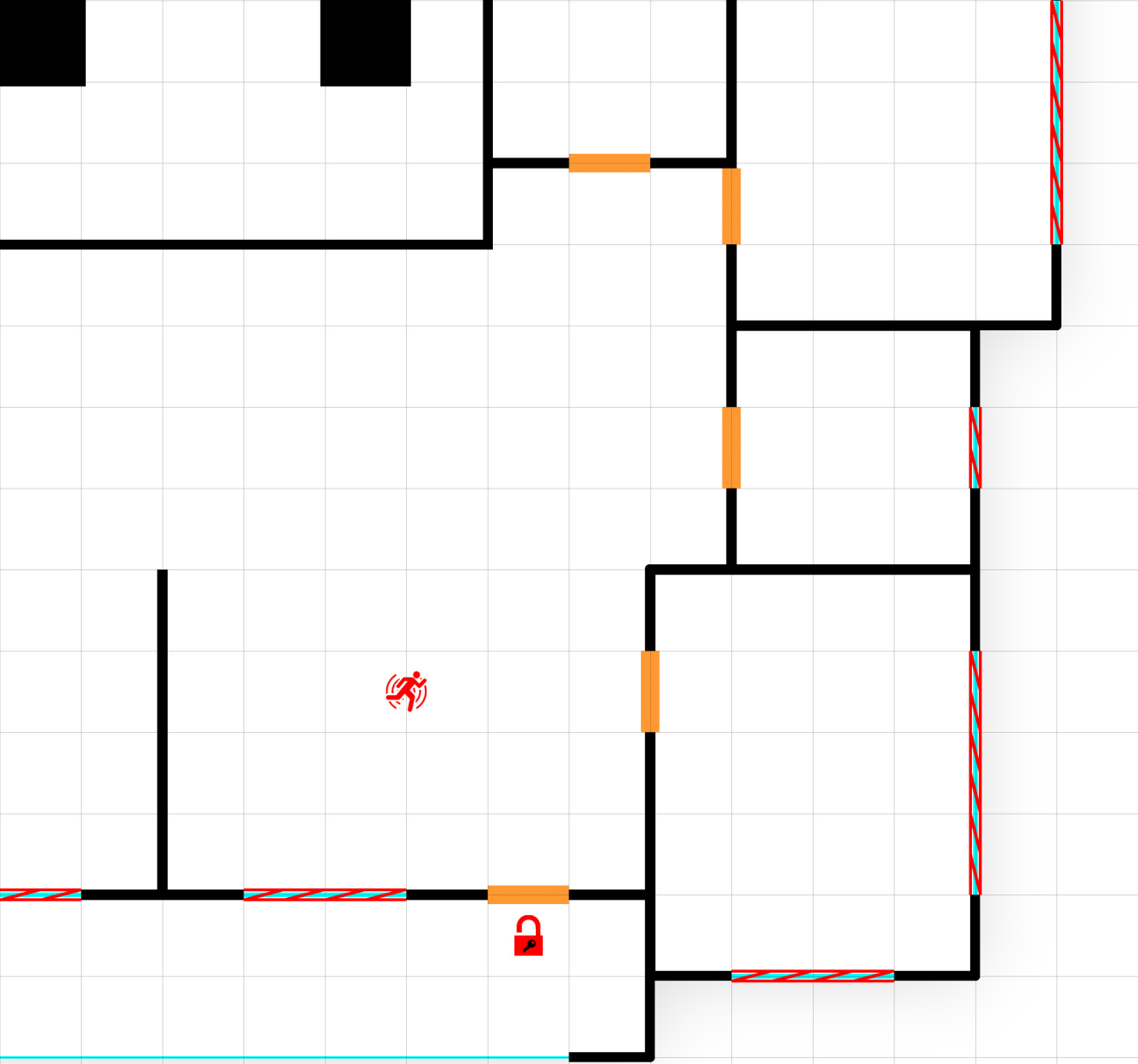



exit









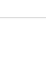



## detection.

-  pressure sensor  
SRS 361
-  camera  
SRS 361
-  trip beam  
SRS 360
-  wire alarm  
SRS 360

-  Magnetic Anomaly Detector  
SRS 362
-  Millimeter Wave Detector  
SRS 362
-  motion sensor  
SRS 361
-  olfactory scanner  
SRS 361
-  sound detector  
SRS 361

## locks.

-  cardreader  
SRS 359
-  keypad  
SRS 359
-  transponder  
SRS 359
-  key  
SRS 359

-  facial recognition  
SRS 360
-  dna scanner  
SRS 360
-  voice recognition  
SRS 360
-  print scanner  
SRS 360

[legend]

shadowrun 5e  
security overlay